



THE RETROFIT SOURCE
The Best Brands in Automotive Lighting

support@theretrofitsource.com
404.220.7940

INSTALLATION GUIDE:

2013+ ACCORD RETROQUIK SYSTEM

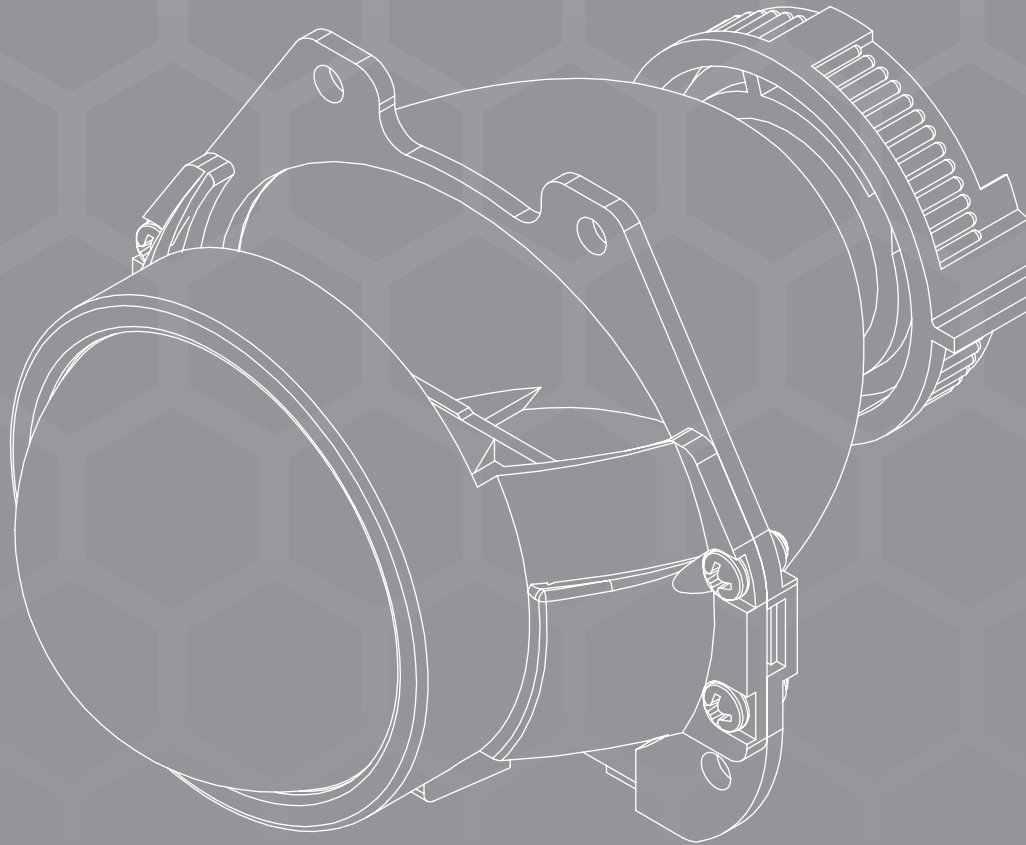



WARNING: By reading this document, I agree it is only to be used as an educational guide. The Retrofit Source makes no guarantee on any finished results, nor are they to be held responsible for any damage, misuse, or personal injuries. Use at your own risk. If you are unable to clearly understand and adapt the information below to your own application, professional installation is recommended.

TABLE OF CONTENTS

| | |
|----------------------|---|
| System Diagram | 3 |
| Opening Headlights | 4 |
| Resealing Headlights | 5 |
| Harness Installation | 7 |
| Solenoid Wiring | 7 |
| Bulb Installation | 7 |
| Ballast Installation | 8 |

STANDARD PARTS

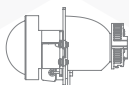

2x 4TL-R Projectors

INCLUDED WITH COMPLETE KIT



1x Ballast Test Lead

OPTIONAL PARTS



2x D2S HID Bulbs



2x Morimoto XB Ballasts



2x Morimoto XB D2S Igniters



1x Wire Harness



2x High Beam Splitters



1x RetroRubber Sealant

SPECIAL NOTE:



Ballast Test Lead

The included ballast test lead is used for troubleshooting purposes only and is not part of the installation of this system. If necessary, the test lead can be plugged into the ballast input then connected to a 12V+ source to test the ballast. This must be done with the bulb connected to the ballast prior to applying power.

SYSTEM DIAGRAM

Side Closer to Battery

Side Further from Battery

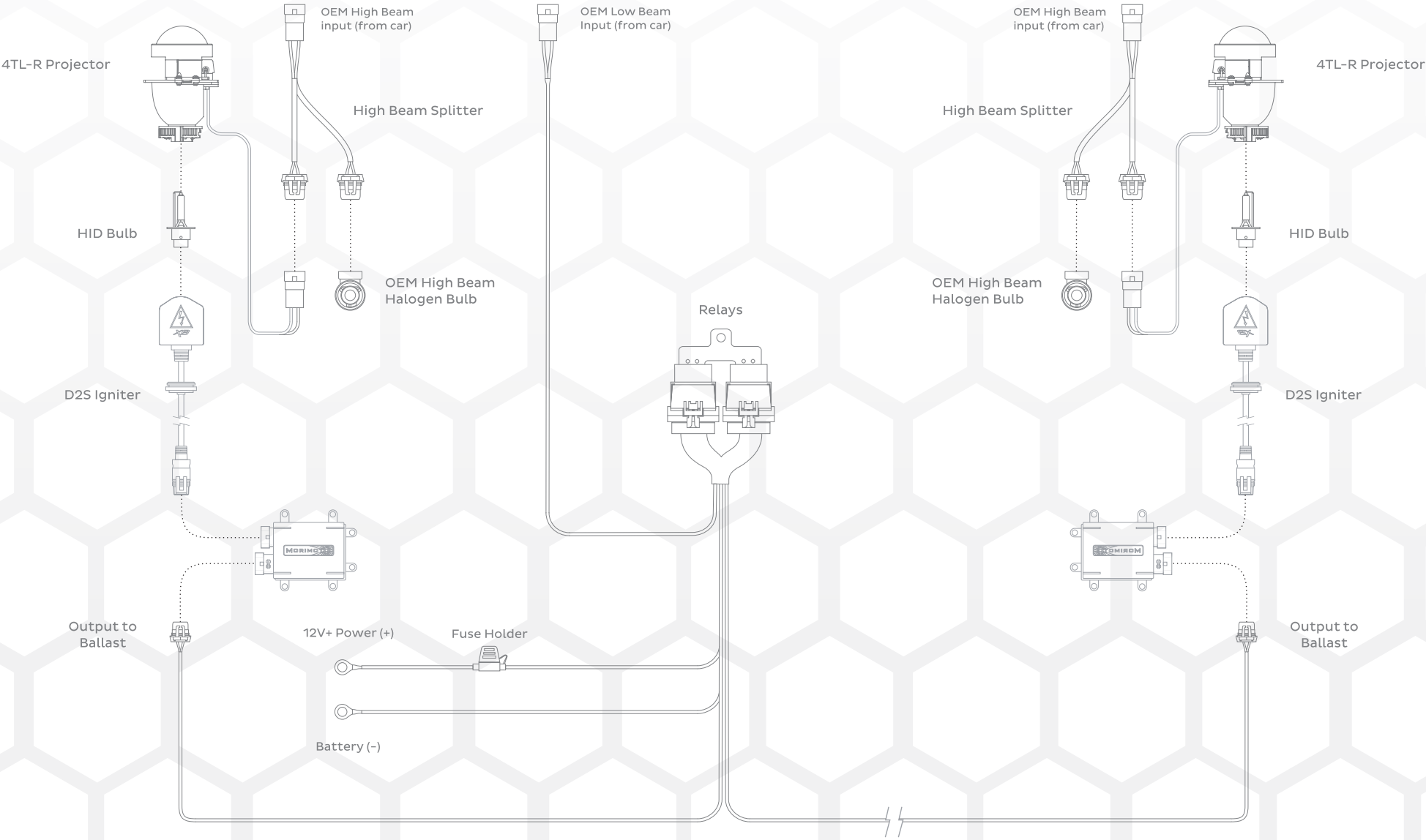

OPENING HEADLIGHTS

1

Place headlight in oven for seven (7) minutes at 270 Fahrenheit / 130 Celsius to soften the existing sealant. Be sure no wires or other hanging parts are touching the wire rack.

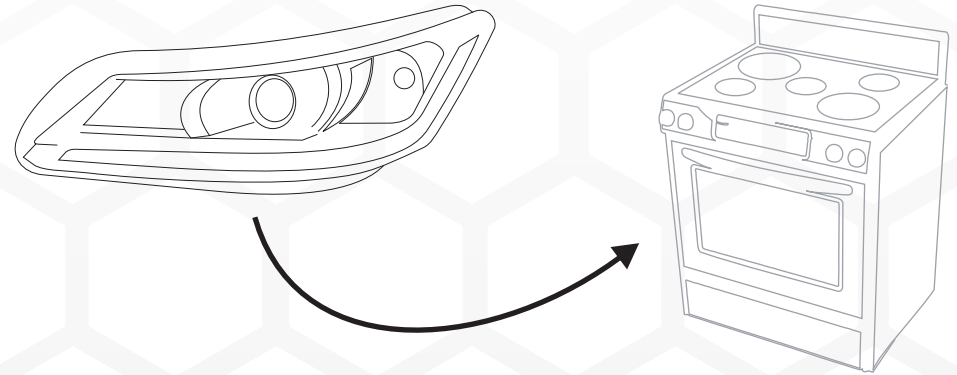

2

Using a flathead screwdriver, pry gently on the seam holding the two housing halves together to separate them.

NOTE: Gloves are recommended!

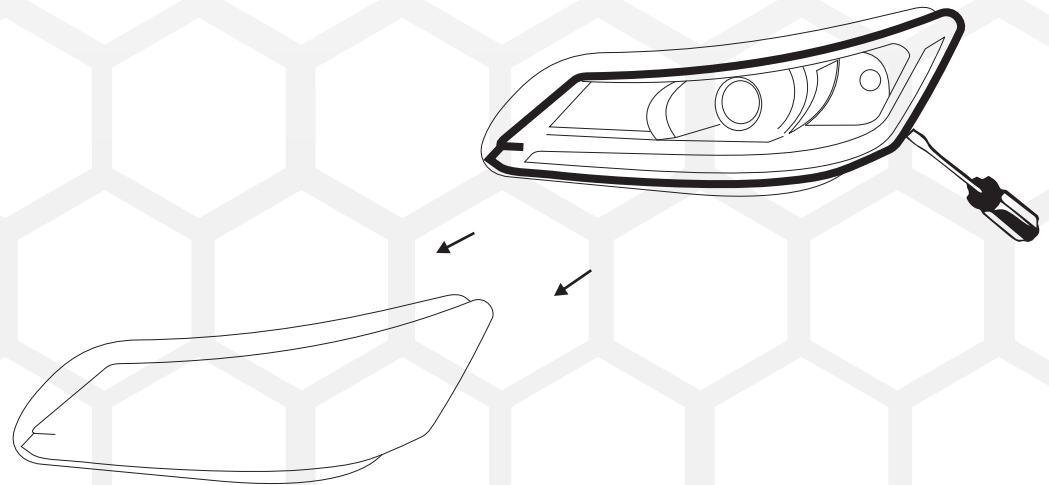

RESEALING HEADLIGHTS

1

Because the stock sealant cannot be reused, remove all of the existing sealant from the channel and edge of the headlight lens.



2

Place bead of RetroRubber sealant in channel of headlight housing as shown. Fill the majority of the channel to ensure it sufficiently holds the front lens once re-installed.

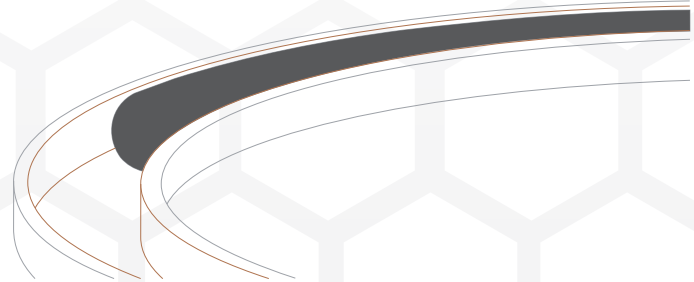

3

Use scissors to cut the RetroRubber once the entire circumference of the housing has been filled.

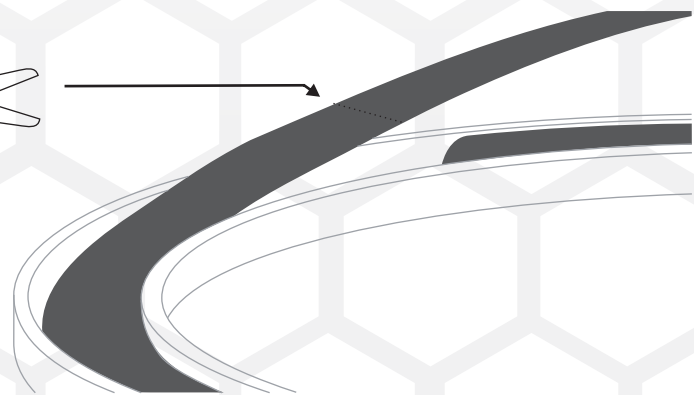
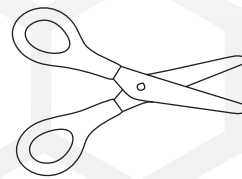

4

Re-fit headlight lens back over channel in headlight housing and press gently.

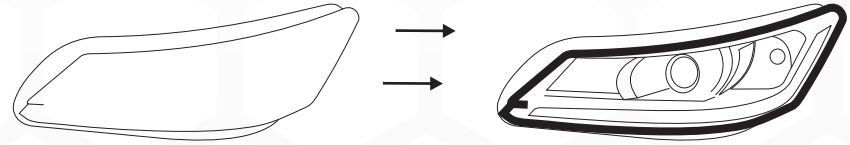

5

Place entire headlight in oven for seven (7) minutes at 270 Fahrenheit / 130 Celsius to soften the new sealant.

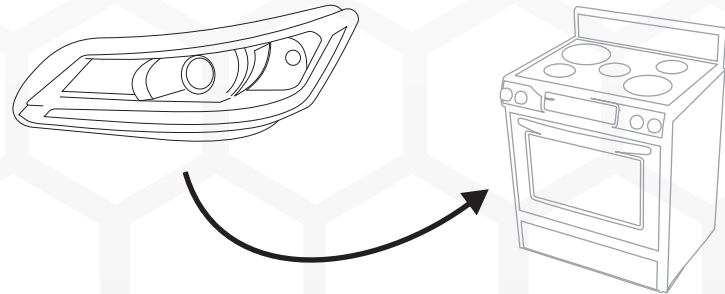

6

Using pliers, squeeze the channel back together snugly to ensure the RetroRubber creates a proper seal.

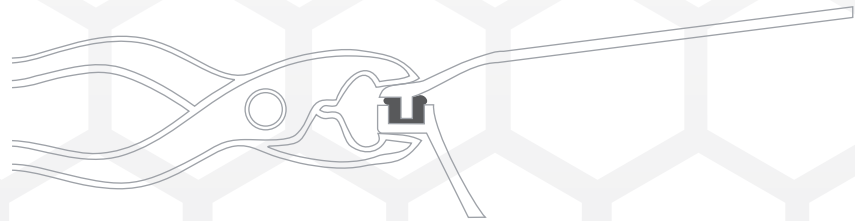

7

Allow thirty (30) minutes for headlight to sufficiently cool down prior to re-installation on car.

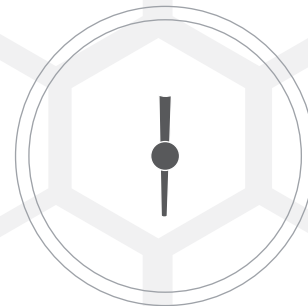

00:30:00

HARNESS INSTALLATION

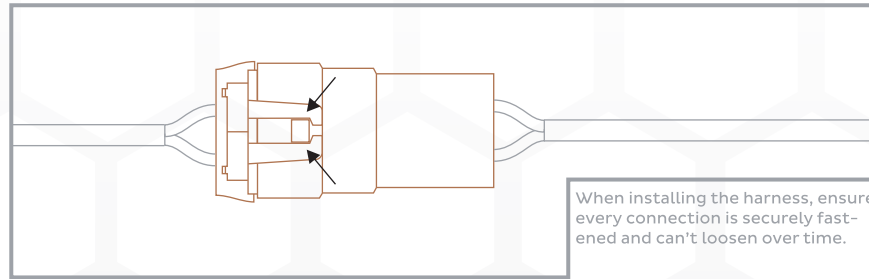

When installing the harness, ensure every connection is securely fastened and can't loosen over time.

SOLENOID WIRING

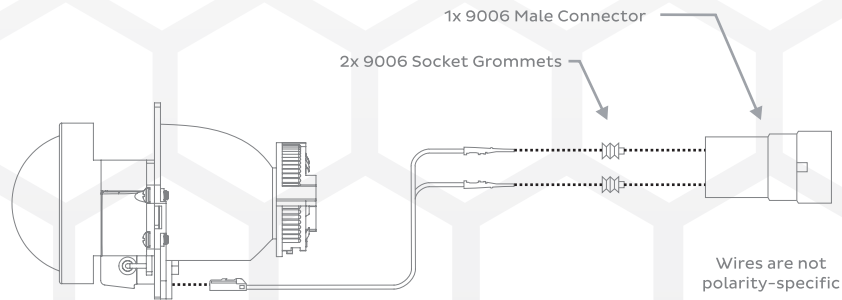

BULB INSTALLATION



Do not ignite until fully connected



Waterproof

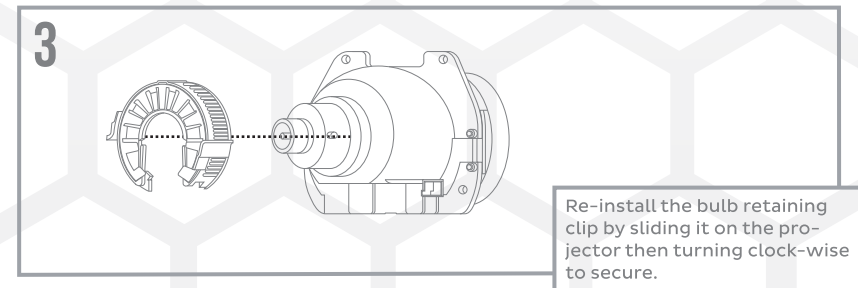
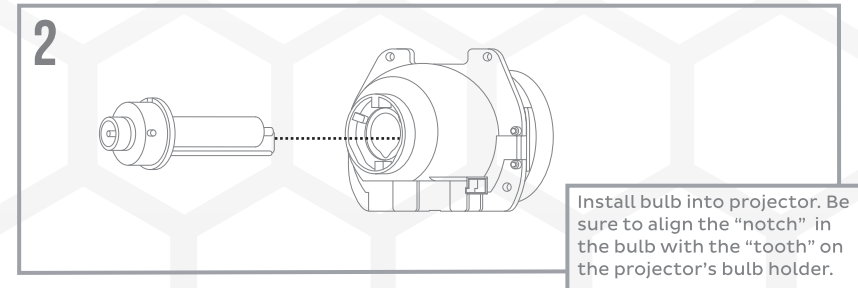
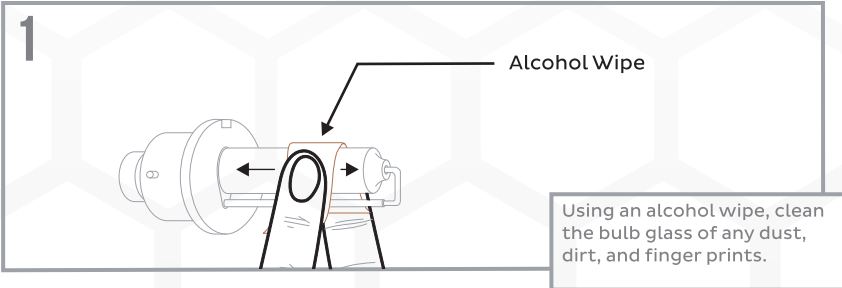

BALLAST INSTALLATION



Ballasts are waterproof



Do not ignite until fully connected

1

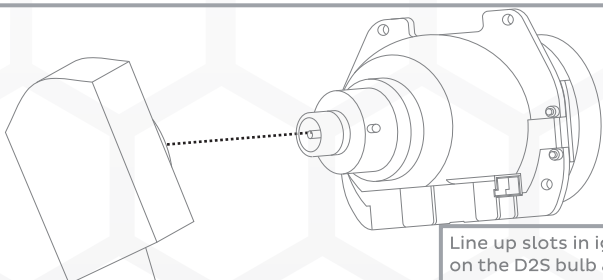

Line up slots in igniter with the tabs on the D2S bulb and slide the igniter on to the bulb.

2

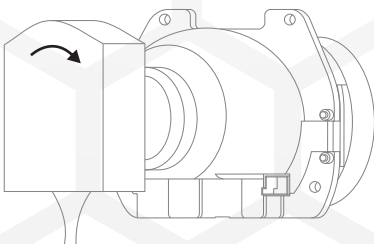

With the igniter pressed fully on to the bulb, turn the igniter clockwise and lock the igniter on to the bulb. You will feel a "click" upon doing this.

3

Recommended mounting:

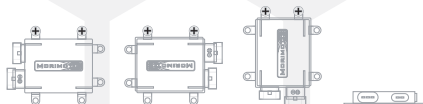

Do not mount ballast with connectors aimed upward!

-END-